

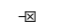









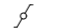

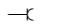

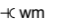

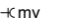
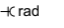
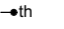
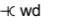
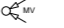
Type DS2th,
Bouwnummer 41



electra conform NEN 1010

-  videodeurbel (bel met videofunctie)
-  wandlichtpunt
-  plafondlichtpunt
-  enkelpolige schakelaar
-  wisselchakelaar
-  serieschakelaar
-  wandcontactdoos dubbel geaard, horizontaal
-  wandcontactdoos enkel geaard
-  wand-/rookmelder (aangesloten op lichtnet)
conform NEN2555
-  aansluiting wasmachine
-  aansluiting pv-panelen
-  aansluiting mechanische ventilatie
-  aansluiting radiator
-  kamerthermostaat
-  loze leiding wasdroger
-  afzuigpunt mech.vent.
-  Buitenkraan
-  Bewegingsmelder
-  schoorsteen tbv. ventilatie berging

bouwkundig

-  meterkast
-  MV-box
-  warmtepomp
-  opstelplaats droger/wasmachine
-  kruipluik
-  boiler
-  CV-verdeler
-  radiator
-  woningsscheidende wand
-  binnenwand 70mm / 100mm
-  gevelpakket
-  gevelsteen-spouw-isolatie-binnenblad
-  tegelwerk
-  Loopdeur
-  HWA

GBO slaapkamer = gemeten tot 1500+lijn
opp. slaapkamer = gemeten conform
verblijfsruimte

ZVA

Zeinstra Veerbeek Architecten

ILSY-Plantsoen 5
2497 GA Den Haag

Telefoon: +31 703478594
info@zeinstraveerbeek.nl
www.zeinstraveerbeek.nl

Project:
Weespersluis, Lanenrijk 2A2; Weesp

Fase:
Verkooptekening

Schaal:
1:100

formaat:
A3

Datum:
20-08-2020

project nummer:
0453

tekening nummer:
KAO-DS2th-100

tekening naam:
Voorblad

Type:
rijwoning 6000 DS2th

Getekend:
SVL

Type DS2th,
Bouwnummer
41

— LANENRIJK —

AM

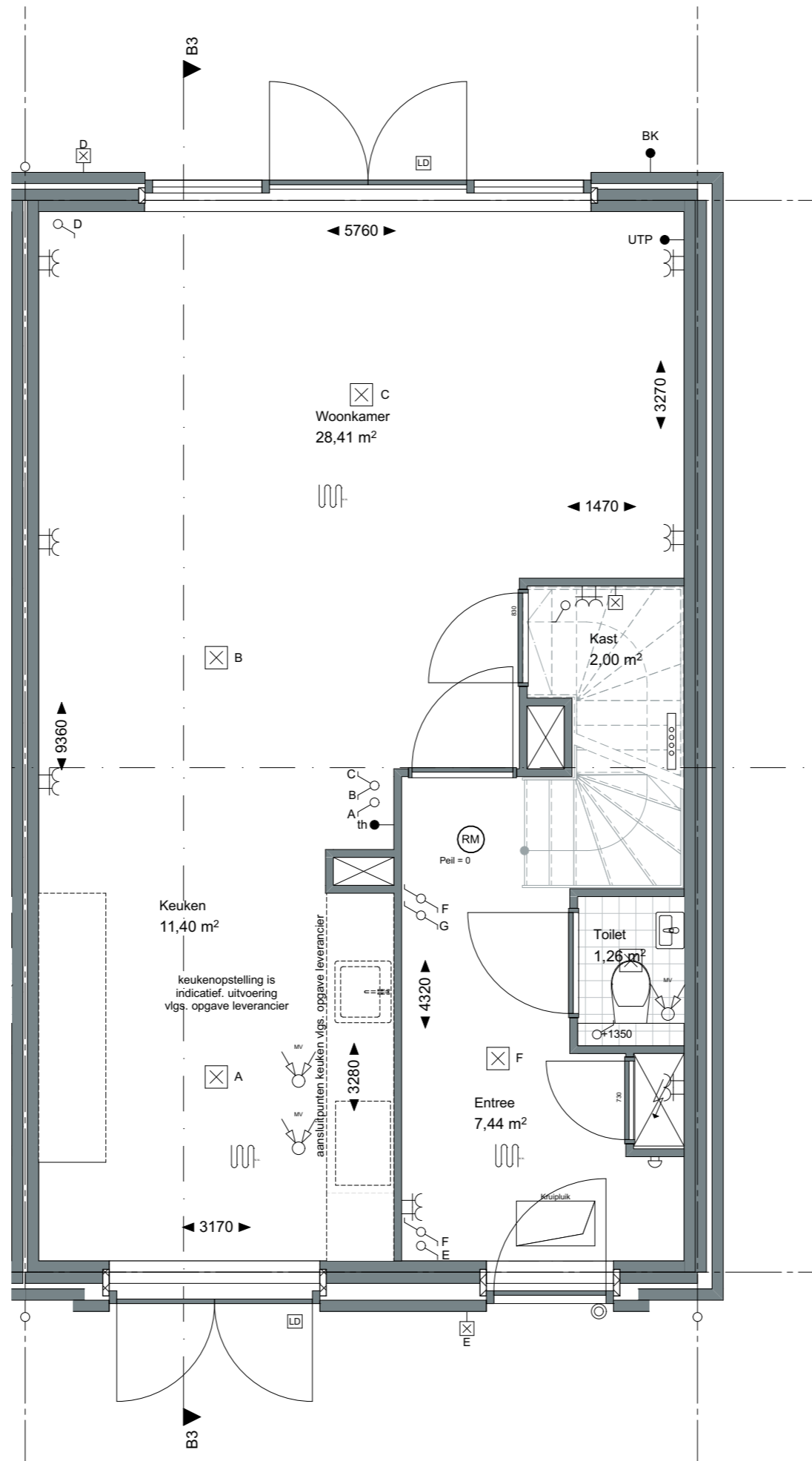

ZVA

Zeinstra Veerbeek Architecten

ILSY-Plantsoen 5
2497 GA Den Haag

Telefoon: +31 703478594
info@zeinstraveerbeek.nl
www.zeinstraveerbeek.nl

Project:
Weespersluis, Lanenrijk 2A2; Weesp

Fase:
Verkooptekening

Schaal:
1:50

formaat:
A3

Datum:
20-08-2020

project nummer:
0453

tekening nummer:
KAO-DS2th-101

tekening naam:
Begane grond

Type:
rijwoning 6000 DS2th

Getekend:
SVL

Type DS2th,
Bouwnummer
41



— LANENRIJK —



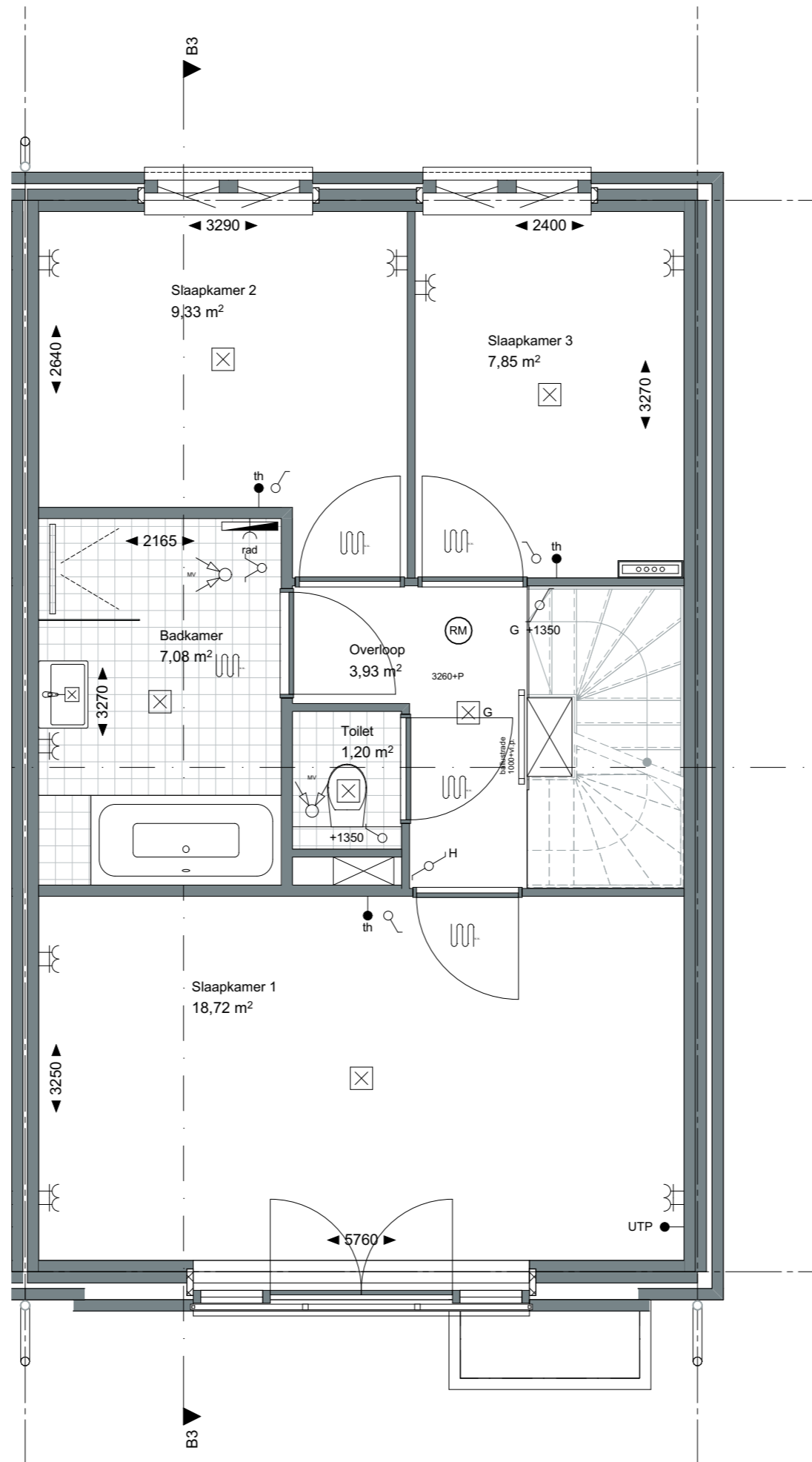

ZVA

Zeinstra Veerbeek Architecten

ILSY-Plantsoen 5
2497 GA Den Haag

Telefoon: +31 703478594
info@zeinstraveerbeek.nl
www.zeinstraveerbeek.nl

Project:
Weespersluis, Lanenrijk 2A2; Weesp

Fase:
Verkooptekening

Schaal:
1:50

formaat:
A3

Datum:
20-08-2020

project nummer:
0453

tekening nummer:
KAO-DS2th-102

tekening naam:
Eerste verdieping

Type:
rijwoning 6000 DS2th

Getekend:
SVL

Type DS2th,
Bouwnummer
41



— LANENRIJK —

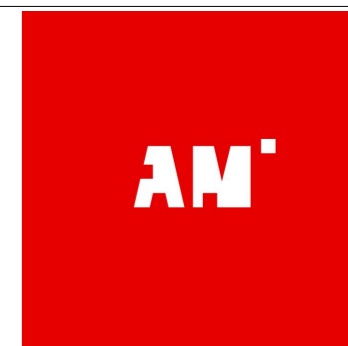

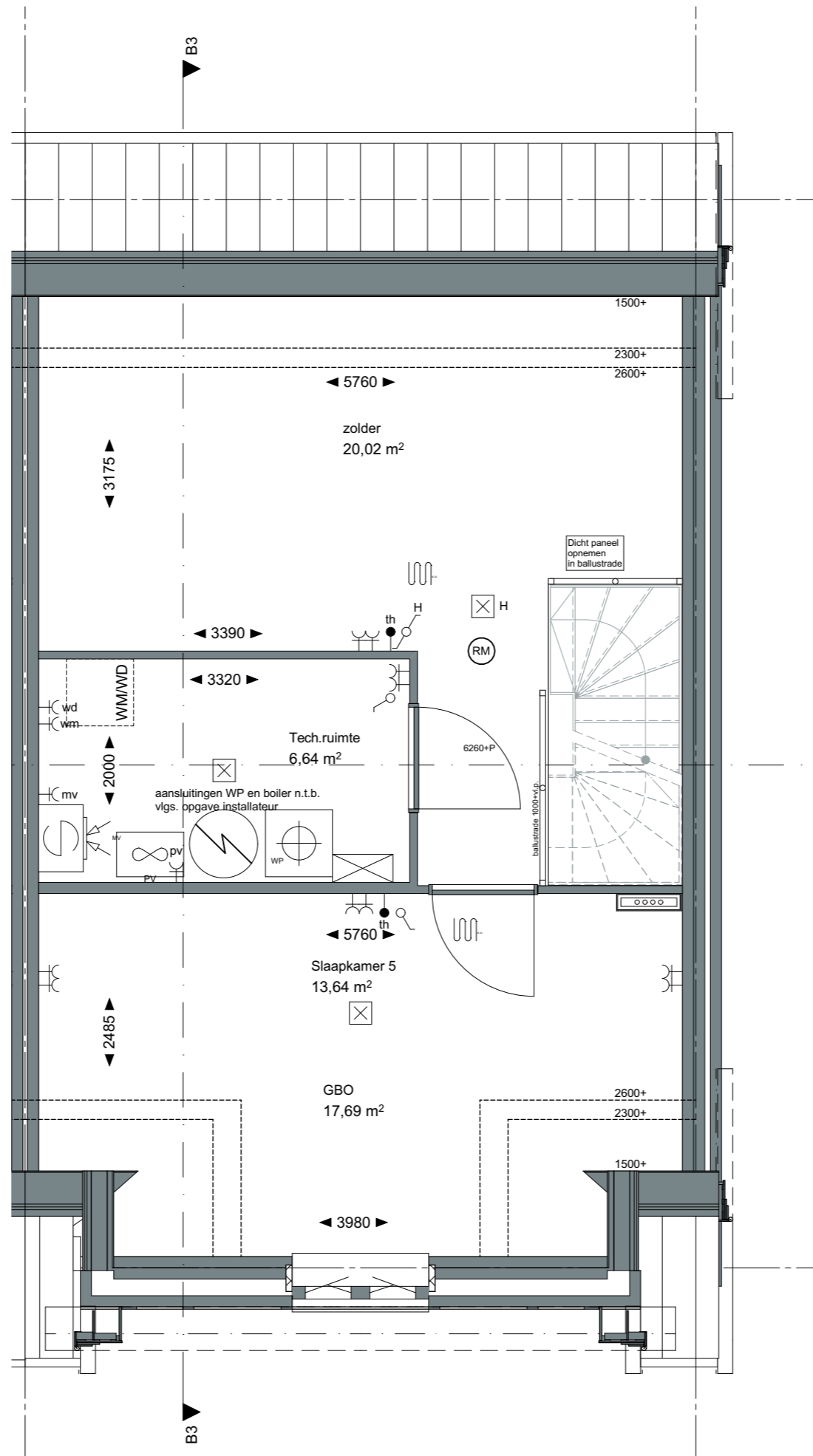

ZVA

Zeinstra Veerbeek Architecten

ILSY-Plantsoen 5
2497 GA Den Haag

Telefoon: +31 703478594
info@zeinstraveerbeek.nl
www.zeinstraveerbeek.nl

Project:
Weesperluis, Lanenrijk 2A2; Weesp

Fase:
Verkooptekening

Schaal:
1:50

formaat:
A3

Datum:
20-08-2020

project nummer:
0453

tekening nummer:
KAO-DS2th-103

tekening naam:
Tweede verdieping

Type:
rijwoning 6000 DS2th

Getekend:
SVL

Type DS2th,
Bouwnummer
41

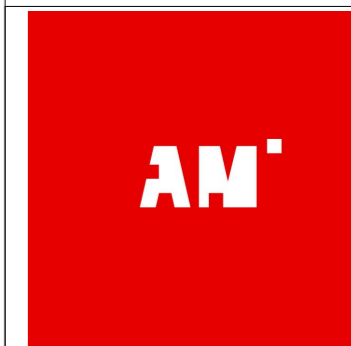

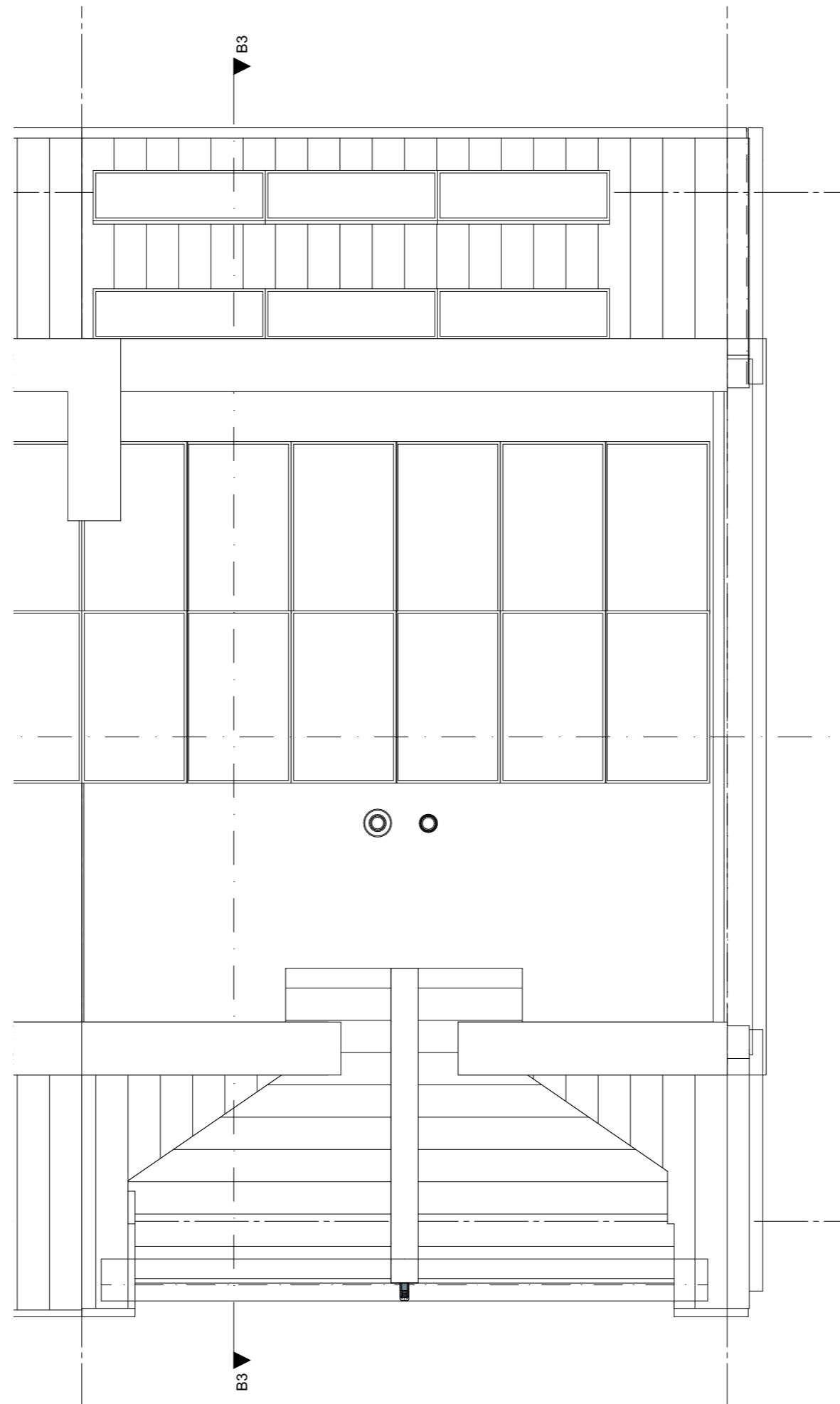

ZVA

Zeinstra Veerbeek Architecten

ILSY-Plantsoen 5
2497 GA Den Haag

Telefoon: +31 703478594
info@zeinstraveerbeek.nl
www.zeinstraveerbeek.nl

Project:
Weespersluis, Lanenrijk 2A2; Weesp

Fase:
Verkooptekening

Schaal:
1:50

formaat:
A3

Datum:
20-08-2020

project nummer:
0453

tekening nummer:
KAO-DS2th-104

tekening naam:
Dakverdieping

Type:
rijwoning 6000 DS2th

Getekend:
SVL

Type DS2th,
Bouwnummer
41

— LANENRIJK —

AM'

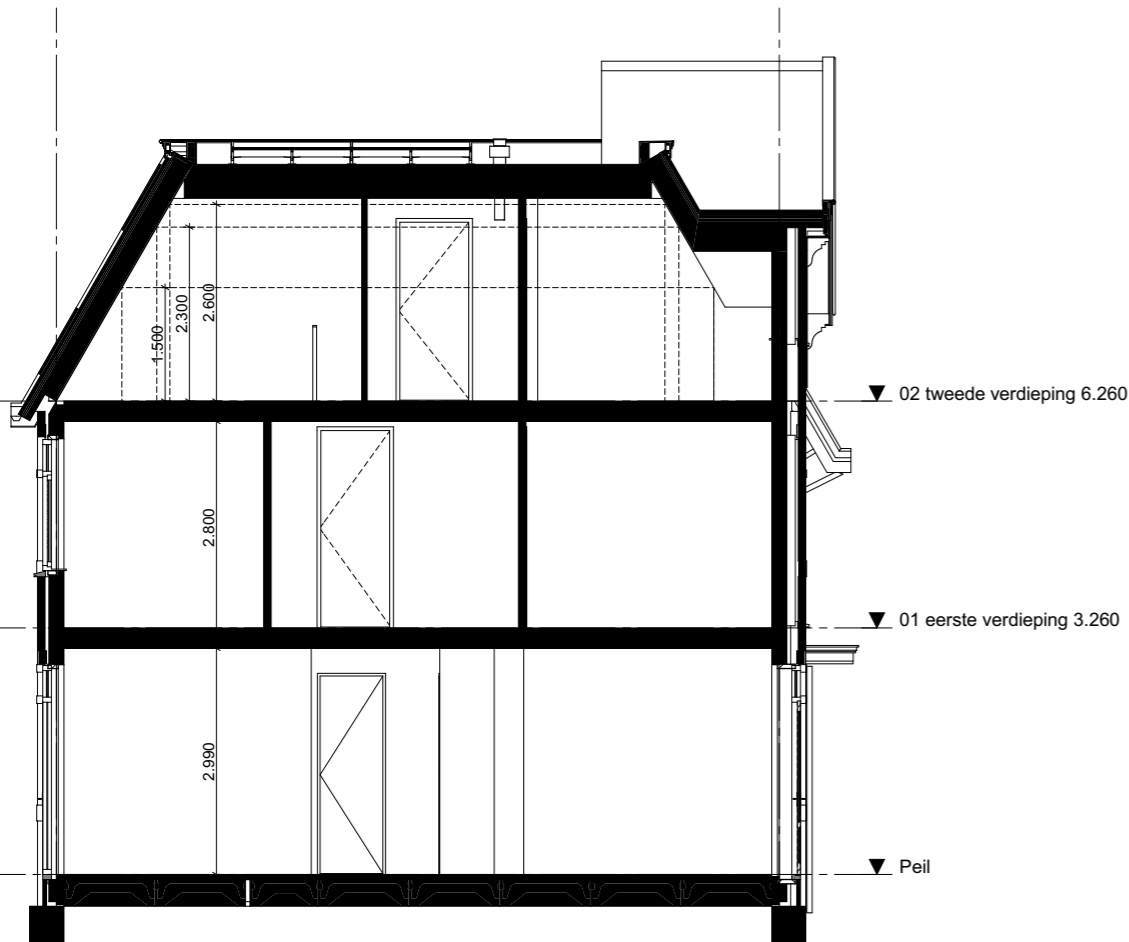
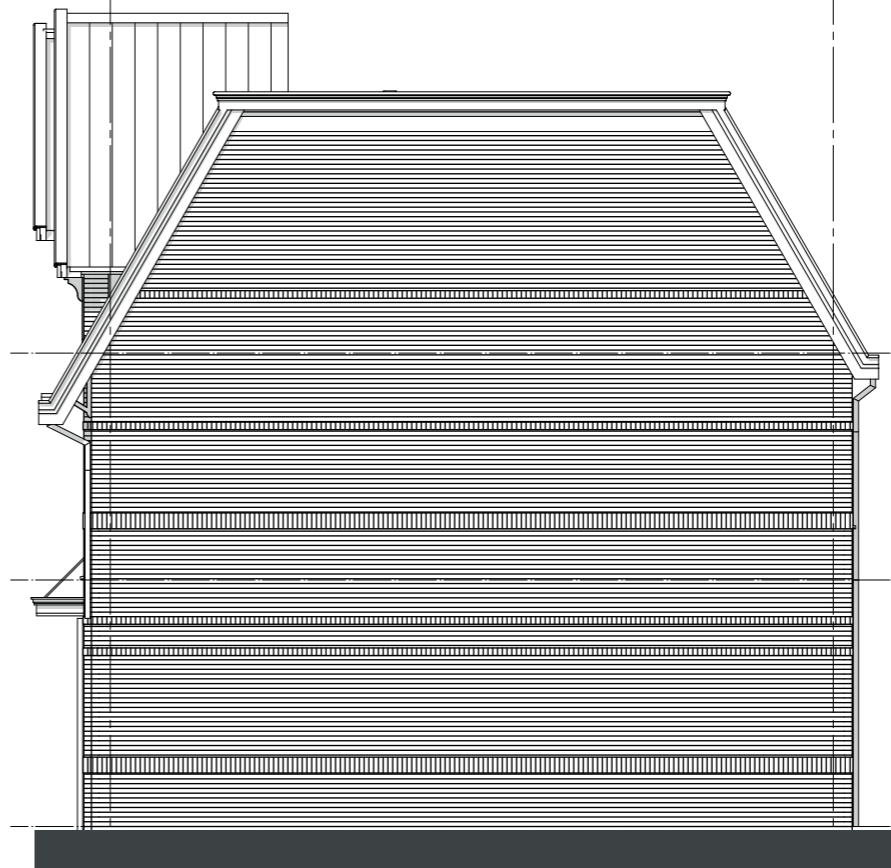

ZVA

Zeinstra Veerbeek Architecten

ILSY-Plantsoen 5
2497 GA Den Haag

Telefoon: +31 703478594
info@zeinstraveerbeek.nl
www.zeinstraveerbeek.nl

Project:
Weespersluis, Lanenrijk 2A2; Weesp

Fase:
Verkooptekening

Schaal:
1:100

formaat:
A3

Datum:
20-08-2020

project nummer:
0453

tekening nummer:
KAO-DS2th-201

tekening naam:
Gevels

Type:
rijwoning 6000 DS2th

Getekend:
SVL

Type DS2th,
Bouwnummer
41



— LANENRIJK —

